

KF Series Gas Fired

Boiler Specifications (KF Series - Gas fired)

Boiler model		KF-750AGE	KF-1000AGE	KF-1500AGE	KF-2000AGE	
Equivalent evaporation	kg/h	750	1,000	1,500	2,000	
Actual evaporation	kg/h	629	839	1,258	1,677	
Maximum working pressure	MPa	0.98				
Heat surface	m ²	4.9		9.8		
Combustion control		3 Positions				
Feed water control		2 Positions				
Used fuel		Natural Gas, LPG				
Gas supply pressure	MPa	0.078 ~ 0.294 (NG)				
Boiler efficiency	%	96		98		
Fuel consumption	m ³ /h	43.4	57.9	85.1	113.4	
Feed water temperature	°C	15 ~ 100				
Holding water quantity	L	148		275		
Dry weight	kg	1,460	1,560	2,400	2,500	
Power supply		AC380V·50Hz·3φ				
Power capacity	Forced draft fan	kW	2.2	5.5	5.5	7.5
	Feed water pump	kW	0.75	1.5	1.5	2.2
	Control panel	kW	0.2			

[NOTE]

- The fuel gas consumption is shown based on the fuel's lower heating value at 40.6 MJ/m³ (NG).
- Equivalent evaporation is specified on condition that feed water of 100°C change into steam of 100°C.
- Actual evaporation is indicated based on the steam pressure of 0.49MPa and the feed water temperature of 15°C.
- Boiler efficiency is indicated based on the steam pressure of 0.49MPa, the feed water temperature of 15°C and the room temperature of 35°C.
- Boiler efficiency shall have the following tolerance. boiler efficiency: ±1%. fuel consumption: ±3.5%.
- Gas supply pressure is the value required to operate at the rated fuel consumption.
- When planning the fuel gas piping, check to see if this gas supply pressure is kept in advance.
- Maximum working pressure exceeding 0.98MPa can be applied as option.
- [OPTION] 1.56MPa
- The parameters described in this table list of specification can be changed by the manufacturer for the purpose of technical improvement without notice.

Dimension

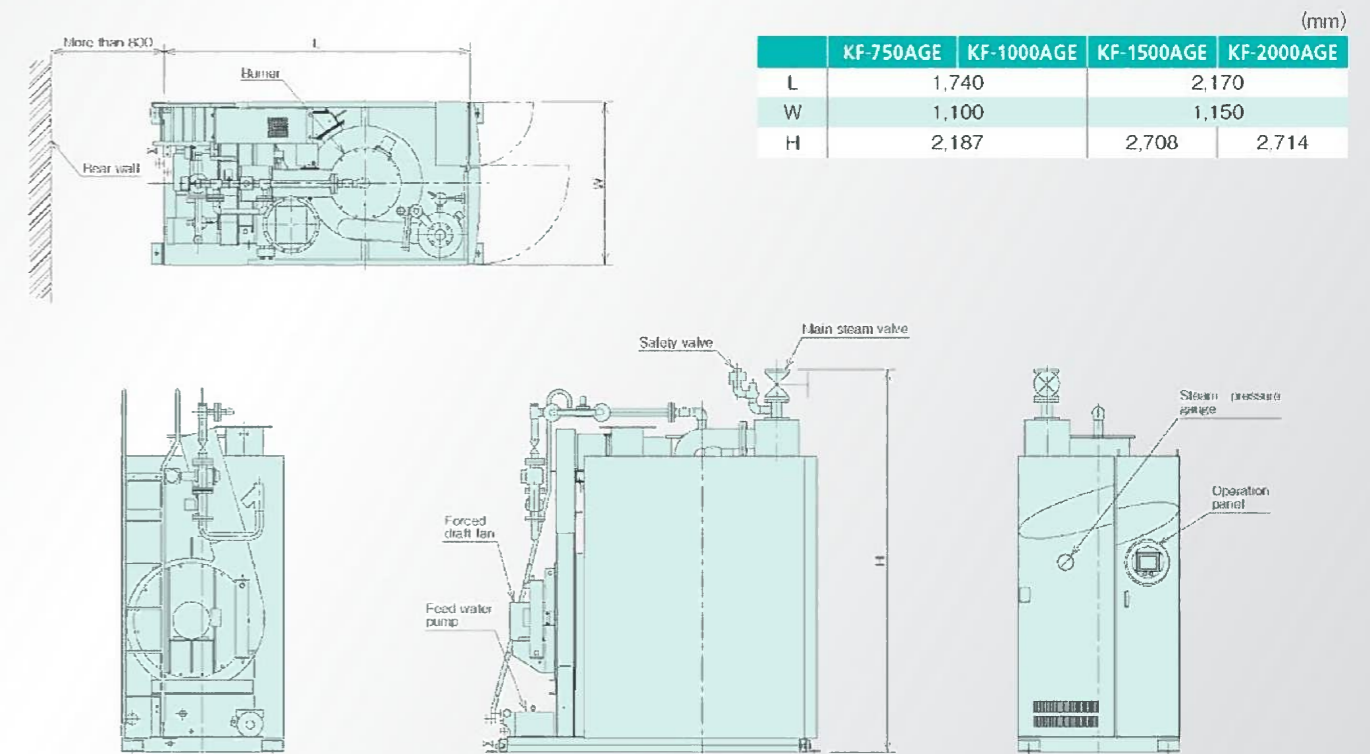

Foundation

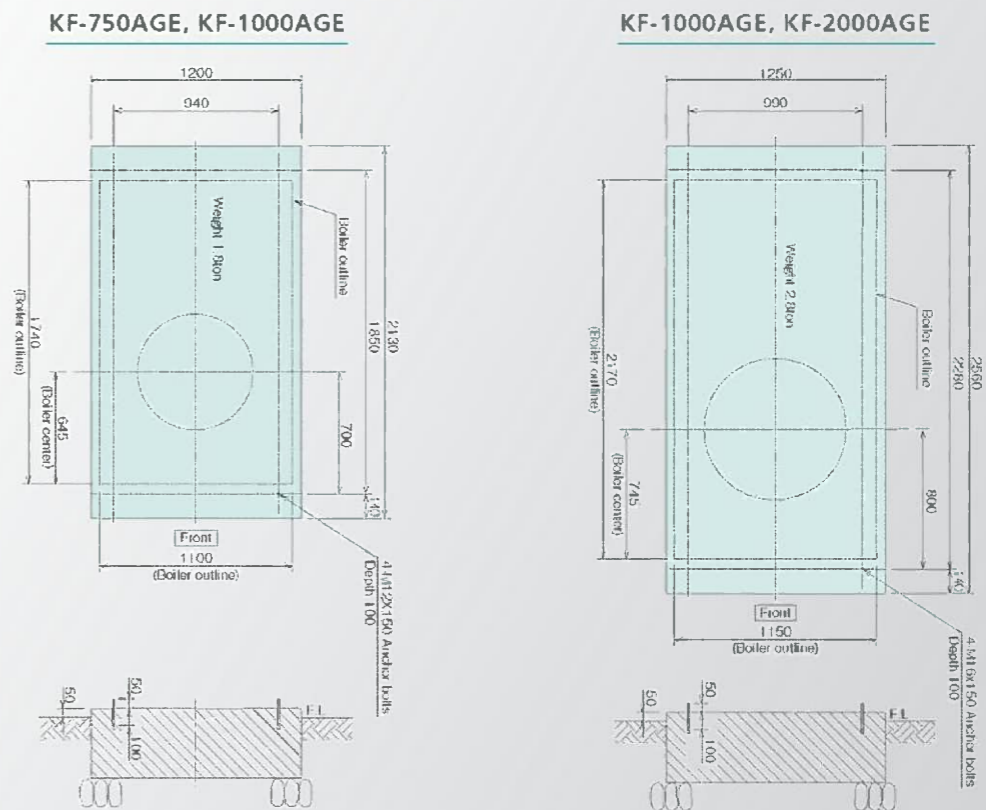

KF Series Oil Fired

Boiler Specifications (KF Series - Oil fired)

Boiler model		KF-750AE	KF-1000AE	KF-1500AE	KF-2000AE	
Equivalent evaporation	kg/h	750	1,000	1,500	2,000	
Actual evaporation	kg/h	629	839	1,258	1,677	
Maximum working pressure	MPa	0.98				
Heat surface	m ²	4.9		9.8		
Combustion control		3 Positions				
Feed water control		2 Positions				
Used fuel		Diesel Oil				
Boiler efficiency	%	95				
Fuel consumption	kg	41.7	55.6	83.4	111.2	
Feed water temperature	°C	55 ~ 100				
Holding water quantity	L	148		275		
Dry weight	kg	1,460	1,560	2,300	2,400	
Power supply		AC380V-50Hz-3φ				
Power capacity	Forced draft fan	kW	2.2	5.5	5.5	7.5
	Feed water pump	kW	0.75	1.5	1.5	2.2
	Feed oil pump	kW	0.4			
	Control panel	kW	0.2			

[NOTE]

- The fuel oil consumption is shown based on the fuel's lower heating value at 42.7 MJ/kg.
- Equivalent evaporation is specified on condition that feed water of 100°C change into steam of 100°C.
- Actual evaporation is indicated based on the steam pressure of 0.49MPa and the feed water temperature of 15°C.
- Boiler efficiency is indicated based on the steam pressure of 0.49MPa, the feed water temperature of 15°C and the room temperature of 35°C.
- Boiler efficiency shall have the following tolerance, boiler efficiency: ±1%, fuel consumption: ±3.5%.
- Maximum working pressure exceeding 0.98MPa can be applied as option.

[OPTION] 1.56MPa

- The parameters described in this table list of specification can be changed by the manufacturer for the purpose of technical improvement without notice.

Dimension

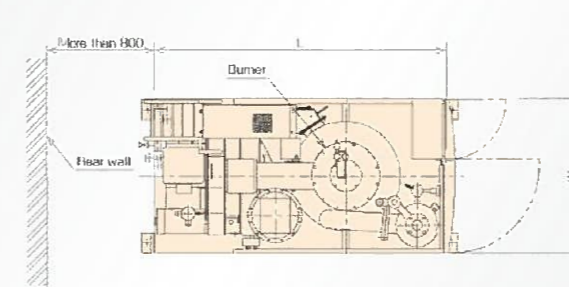

(mm)

	KF-750AE	KF-1000AE	KF-1500AE	KF-2000AE
L	1,740		2,170	
W	1,100		1,150	
H	2,187		2,708	2,714

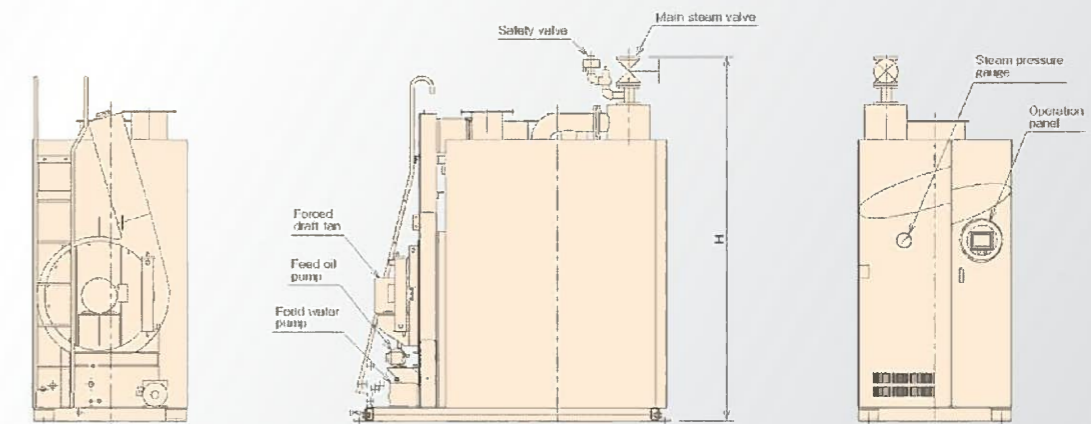

Foundation

