

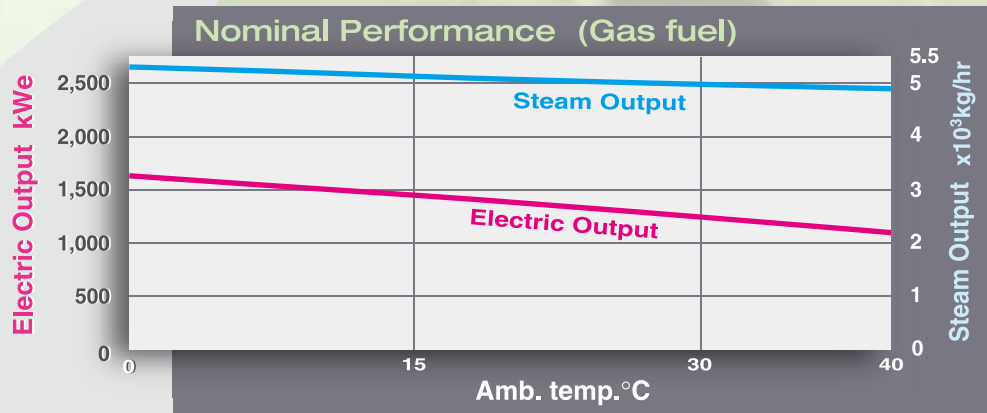

High efficiency : electric 23.6%, overall 79.7%
 Dry low emissions : NOx 25ppmv, CO 50ppmv (O₂ =15%)
 High reliability & easy maintenance



Amb.temp. °C (°F)	Electric Output kWe	Heat Rate kJ/kWe-hr	Steam Output x10 ³ kg/hr	Electrical Efficiency %	Total Thermal Efficiency %
0 (32)	1,630	14,810	5.3	24.3	77.8
15 (59)	1,450	15,280	5.1	23.6	79.7
40 (104)	1,116	17,140	4.9	21.0	82.8

Nominal Performance

Elevation : 0 m
 Inlet Air Temperature : 15 °C
 Inlet Air Pressure Loss : 0.98 kPa
 Exhaust Gas Pressure Loss : 2.45 kPa
 LHV of Natural Gas Fuel : 35.9 MJ/Nm³
 (100% CH₄)

Typical Steam Condition

Steam Pressure : 0.83 MPaG
 Steam Temperature (Saturated) : 177 °C
 Feed Water Temperature : 80 °C
 Blowdown from HRSG : 0 %

● Typical system flow (IN CASE OF GAS FUEL)

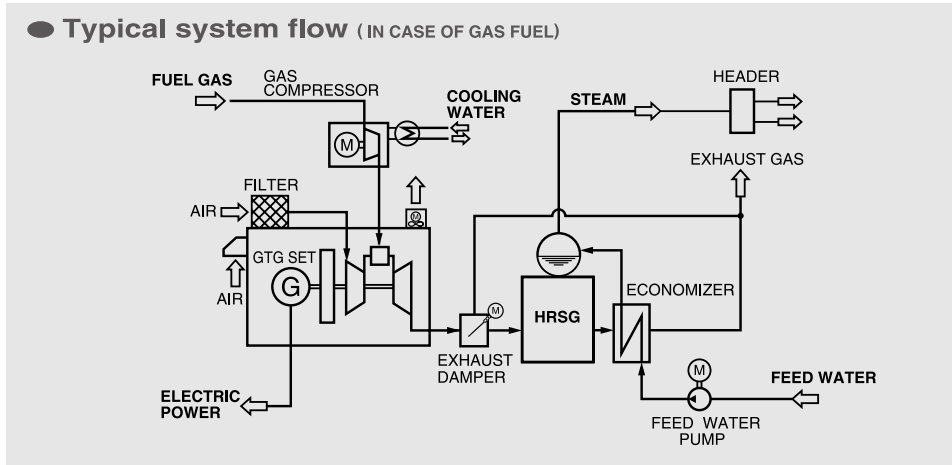

● Typical layout (Unit:mm)

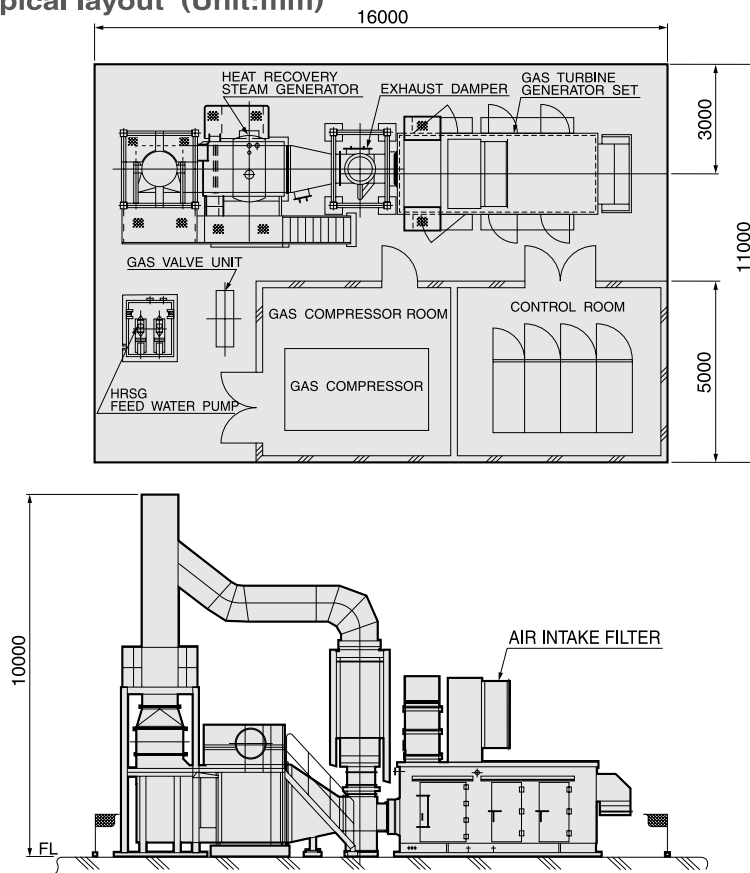

global.kawasaki.com/en/energy/equipment/gas_turbines/index.html

Kawasaki Heavy Industries, Ltd. Tokyo Head Office

Tel:+81-3-3435-2579 Fax:+81-3-3435-2592

Kawasaki Machine Systems, Ltd. (Far East Asia)

Tel:+81-3-3435-2977 Fax:+81-3-3435-2592

Kawasaki Machine Systems, Ltd. Korea Branch

Tel:+82-2-527-2201 Fax:+82-2-527-2205

Kawasaki Gas Turbine Asia Sdn Bhd (KGA)

Tel:+60-3-7846-2882 Fax:60-3-7848-3093

Kawasaki Gas Turbine Europe GmbH (KGE)

Tel:+49-6172-7363-0 Fax:49-6172-7363-55

Kawasaki Gas Turbine Service RUS LLC

Tel:+7-423-262-0201 Fax:+7-423-262-0202

Kawasaki Heavy Industries, Ltd. Bangkok Representative Office

Tel:+66-2-163-2839 Fax:+66-2-163-2841

Kawasaki Gas Turbine Asia Sdn Bhd Jakarta Representative Office

Tel:+62-21508-15125

Kawasaki Gas Turbine Europe GmbH, Romanian Representative Office

Tel:+40-374 645915 Fax:+40-374 094901

Kawasaki Gas Turbine Europe GmbH (Bad Homburg, Germany)

Kawasaki Gas Turbine Europe GmbH (Romanian Rep. Office)

Kawasaki Gas Turbine Service RUS LLC (Vladiostok, Russia)

Kawasaki Machine Systems, Ltd. (Korea Branch)

Kawasaki Heavy Industries, Ltd. Kawasaki Machine Systems, Ltd. (Far East Asia) (Tokyo, Japan)

Kawasaki Heavy Industries, Ltd. (Bangkok Rep. Office)

Kawasaki Gas Turbine Asia Sdn Bhd (Shah Alam, Malaysia)

Kawasaki Gas Turbine Asia Sdn Bhd (Jakarta Rep. Office)

